

I:\DATA\12\Shared\Transportation\Shared\AREA\_SCHMES DELIVERY\PROJECTS\2021-22 Community Board Schemes\Hicks Farm Rise\00 - Drawings\Working\CB-RNG-L01-YY-DE-C-0001\_0002.dwg - 21/11/2022 19:07:32 - Layout1 - Bestman.Agu

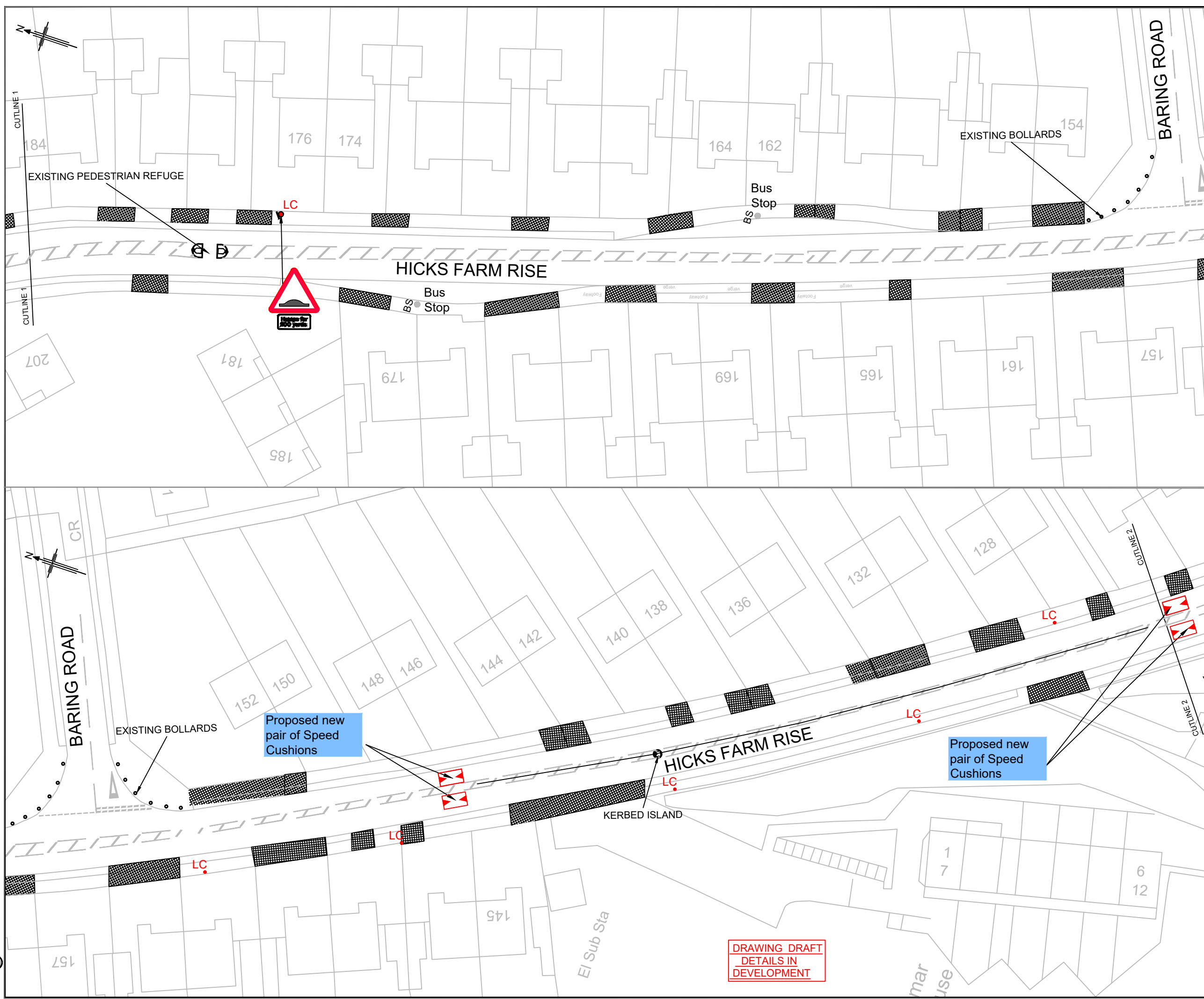

- NOTES :**
1. High Wycombe Community Board has secured funding to implement traffic calming measures on Hicks Farm Rise; between its junction with Baring Road and Gayhurst Road.
  2. The Proposed Details shown are for Consultation purposes and subject to final approval by Buckinghamshire Council - details may be amended, prior to final implementation by TfB.
  3. Existing street furniture positions are marked as approximate. The extent of revised streetlighting is not yet confirmed and all proposed electrical connections have yet to be determined.
  4. The proposals indicated on this plan are based on OS Mapping data, and will be limited to the accuracy of this information.
  5. This plan forms part of the consultation documentation to conform with the Road Traffic Regulation Act 1984.

- KEY :**
- LOCATION OF ACCESSES FROM THE CARRIAGEWAY
  - NEW ROAD HUMP WARNING SIGN TO DIAG 557.1 (WITH SUB PLATE) ON APPROACH TO SPEED CUSHIONS.
  - INDICATIVE SPEED CUSHION POSITION (PREFORMED RECOMMENDED)
  - EXISTING LIGHTING COLUMN.

This map is reproduced from Ordnance Survey material with the permission of the Ordnance Survey on behalf of the Controller of Her Majesty's Stationery Office © Crown copyright. Unauthorised reproduction infringes Crown copyright and may lead to prosecution or civil proceedings. Buckinghamshire County Council 100021529

PO1	28/10/2022	ORIGINAL ISSUE	BA	LB	JP
Rev	Rev. Date	Purpose of revision	Drawn	Checked	Approved

Client: Buckinghamshire Council

The Gateway  
Gatshouse Road  
Aylesbury  
Buckinghamshire  
HP19 8FF

Transport for Buckinghamshire

KEVIN GOAD  
SERVICE DIRECTOR  
HIGHWAYS AND TECHNICAL SERVICES

Project: 2021/2022 COMMUNITY BOARD SCHEME  
HICKS FARM RISE  
TRAFFIC CALMING

Drawing title: **PROPOSED SPEED CUSHIONS  
GENERAL LAYOUT**

**SHEET 1**

Drawing status: **CONSULTATION**

Scale: 1 in 500 @ A3 **DO NOT SCALE**

Project No.: 15213104190000011

Drawing number: **CB-RNGJ-01-YY-DE-C-0001**

Rev: **P01**

**This drawing is not to be used in whole or part other than for the intended purpose and project as defined on this drawing.**

**DRAWING DRAFT  
DETAILS IN  
DEVELOPMENT**